

**System should be installed on solid concrete floor or VCT covered concrete floor.  
Any existing carpet must be removed prior to installation at the rail locations.**

**Floor levelness should meet standard General Contractor code of 1/8" over 10'.**

**Elevation**  
77 3/4" uprights  
7 openings  
6 @ 9 3/4" clear  
1 @ 11 1/4" clear

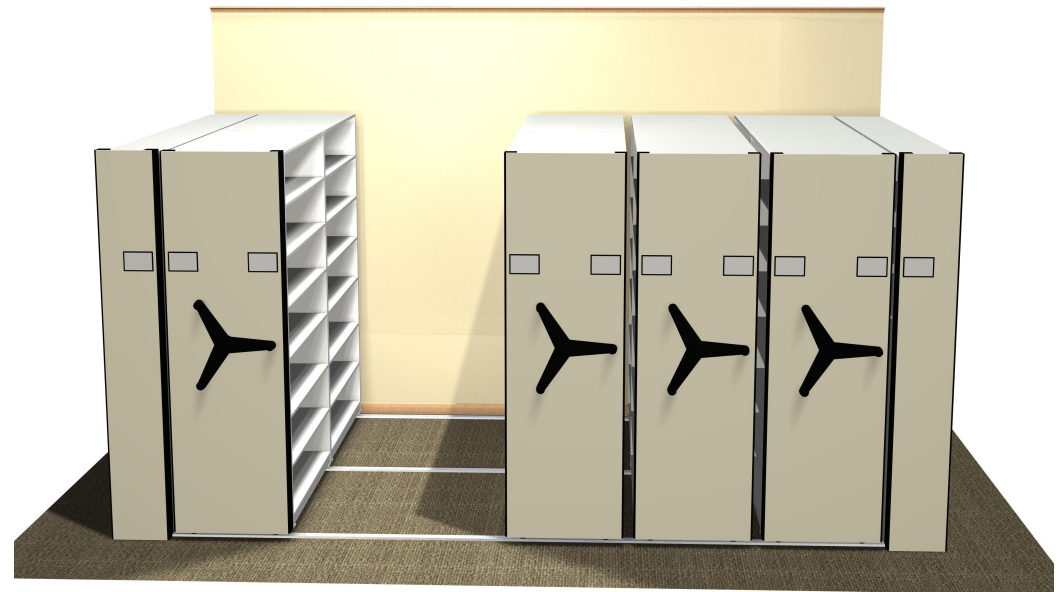
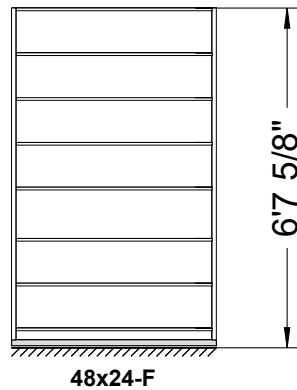

SOUTHWEST**SOLUTIONS**GROUP

*business efficiency systems*

[www.southwestsolutions.com](http://www.southwestsolutions.com)

1-800-803-1083