

Plan View

**Spacesaver Wheelhouse System should be installed on solid concrete floor or VCT covered concrete floor.
Any existing carpet must be removed prior to installation at the rail locations.**

Floor levelness should meet standard General Contractor code of 1/8" over 10'.

7 adjustable openings
6 @ 9 3/4" clear
1 @ 11 1/4" clear

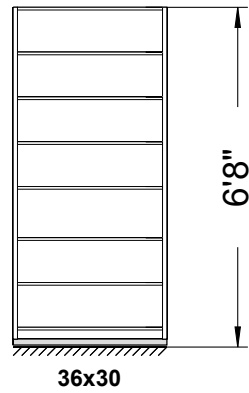

Elevation

