

- 1) MOUNT LATERAL BRACE TO THE LEG ASSEMBLIES USING 5/16" FLAT WASHERS, 5/16" LOCK WASHER AND 5/16" ACORN NUTS. DO NOT TIGHTEN.

BE VERY CAREFUL NOT TO PINCH THE ACTUATOR LINES BETWEEN ANY OF THE PARTS BEING ASSEMBLED AS IT MAY CAUSE DAMAGE TO THOSE LINES

CAUTION: DO NOT PLUG IN UNIT UNTIL IT IS FULLY ASSEMBLED !

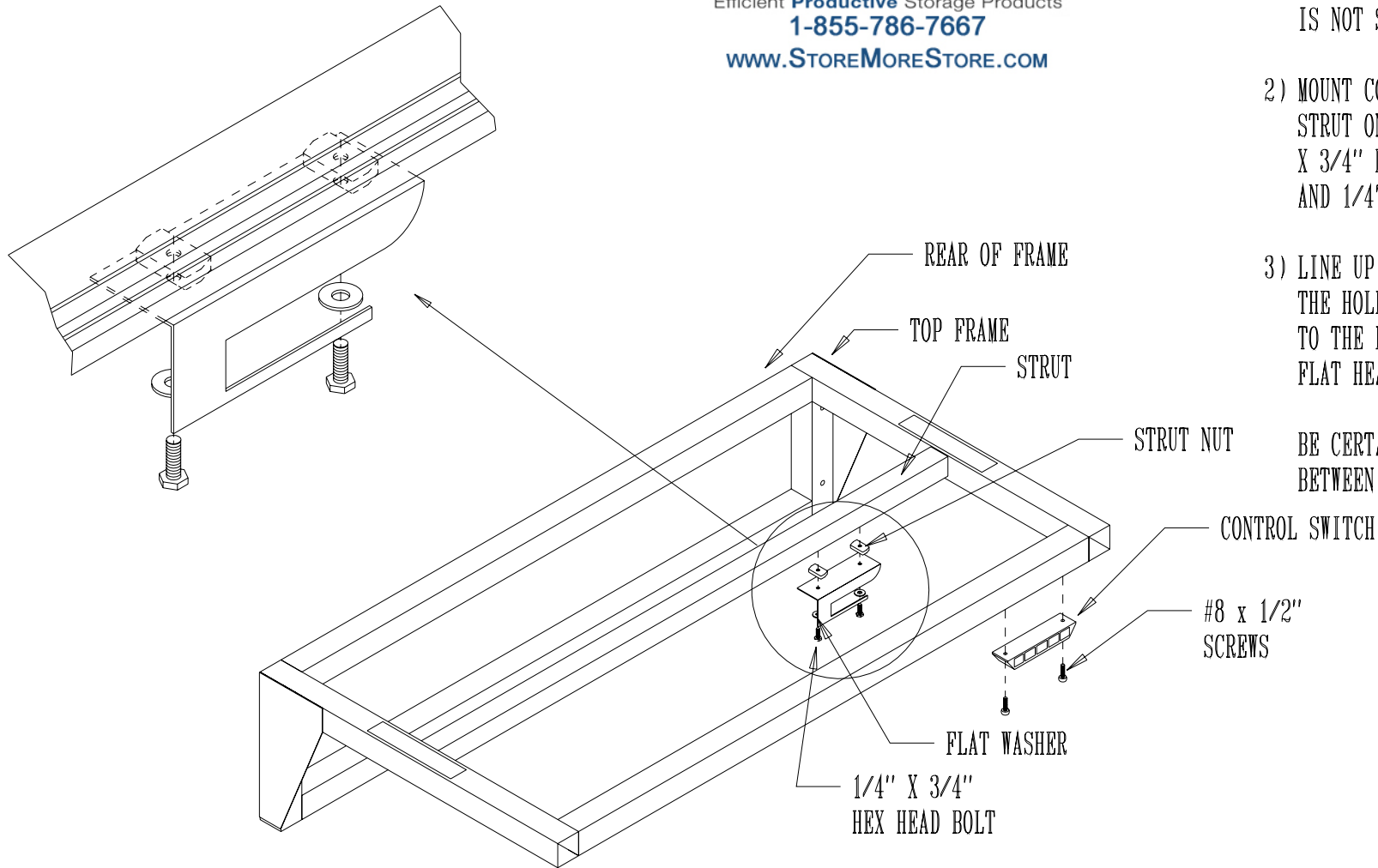

1) FLIP TOP FRAME UPSIDE DOWN ON A PROTECTED SURFACE. (NOTE: TOP FRAME IS NOT SHOWN IN FLIPPED POSITION).

2) MOUNT CONTROL BOX BRACKET TO THE STRUT ON THE TOP FRAME USING 1/4" - 20 X 3/4" HEX HEAD BOLTS, FLAT WASHERS AND 1/4" - 20 STRUT NUTS.

3) LINE UP THE HOLES IN THE FRONT RAIL WITH THE HOLES IN THE CONTROL SWITCH AND MOUNT TO THE FRONT RAIL USING #8 X 1/2" PHILLIPS FLAT HEAD SCREW.

BE CERTAIN NOT TO PINCH THE ACTUATOR LINES BETWEEN ANY PARTS BEING ASSEMBLED

CAUTION: DO NOT PLUG IN UNIT UNTIL IT IS FULLY ASSEMBLED !

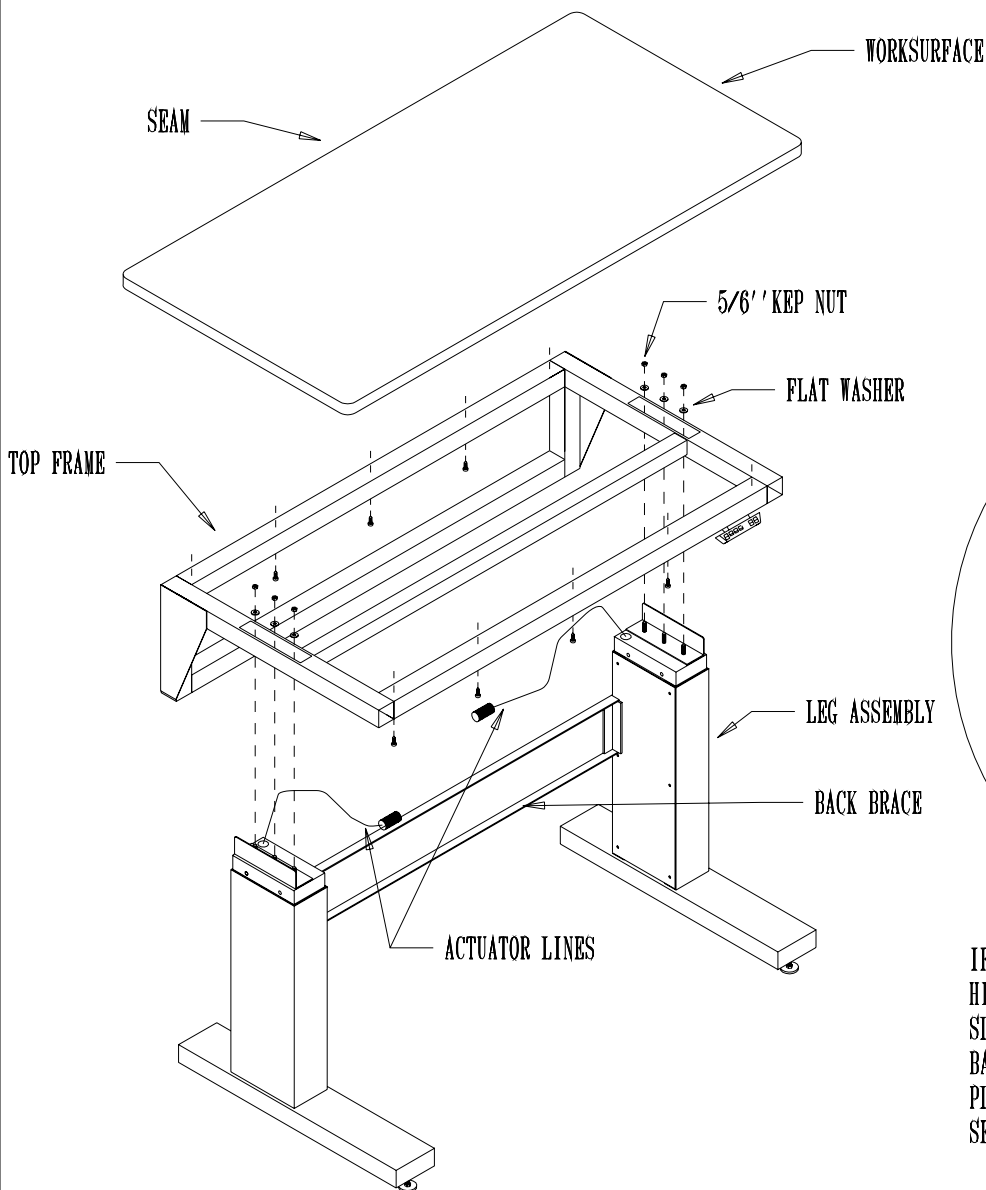

CAUTION: DO NOT PLUG IN UNIT UNTIL IT IS FULLY ASSEMBLED !

- 1) MOUNT TOP FRAME TO THE LEG ASSEMBLIES
USING 5/16" KEP NUTS AND 5/16" FLAT WASHERS
BE CERTAIN NOT TO PINCH THE ACTUATOR LINES
BETWEEN ANY PARTS BEING ASSEMBLED.

AT THIS POINT STRAIGHTEN AND PLUMB THE BASE
LEGS AND TIGHTEN THE BOLTS ON THE BACK BRACE
(REFERENCE DRAWING #A7301 LINE ITEM #1)

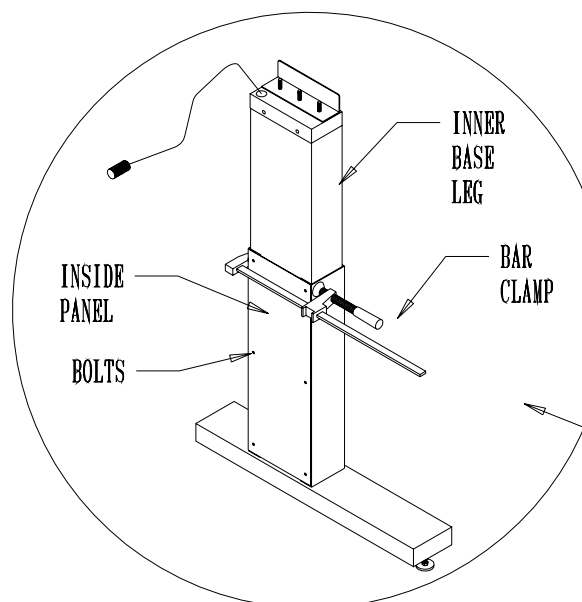

- 2) MOUNT WORKSURFACE TO THE TOP FRAME
USING #12 X 3/4" PHILLIPS PAN HEAD SCREWS
MAKING CERTAIN THERE IS EQUAL OVERHANG
ON EITHER SIDE AND THAT THE BACK OF THE
WORKSURFACE IS FLUSH WITH THE BACK OF
THE TOP FRAME.
(NOTE THE PLACEMENT OF THE SEAM IN THE "T" MOLD)
BE CERTAIN NOT TO PINCH THE ACTUATOR LINES
BETWEEN ANY PARTS BEING ASSEMBLED.

LEG SHOWN REMOVED
FROM BENCH FOR CLARITY
PURPOSES ONLY DO NOT
DISASSEMBLE BENCH FOR
THIS STEP

IF THE INNER BASE LEG SEEMS TO WOBBLER WHEN THE BENCH IS AT ITS
HIGHEST MOST POINT, LEAVE IT AT THAT HEIGHT AND LOOSEN
SLIGHTLY THE 6 ACORN NUTS ON THE SIDE PANEL. THEN USING A
BAR CLAMP OR EQUIVALENT, TIGHTEN CHANNEL SLIGHTLY UNTIL
PLAY HAS BEEN REMOVED. NOW RETIGHTEN ACORN NUTS
SECURELY BEFORE REMOVING CLAMP. DO NOT OVERTIGHTEN !

NOTE: DO NOT ATTEMPT TO OPERATE THE BENCH
UNTIL ALL THE JACKS ARE FIRMLY IN PLACE.
DOING SO WILL CAUSE DAMAGE TO THE ACTUATORS

1) SLIDE CONTROL BOX ONTO CONTROL BOX BRACKET AS SHOWN.

2) BEND THE TAB SO THAT IT SECURES THE CONTROL BOX IN PLACE.

2) PLUG THE JACKS INTO THE PROPER PORTS AS SHOWN BEING CAREFUL TO LINE UP THE NOTCH ON THE PLUG WITH THE GROOVE IN THE PORT BEFORE INSERTING (SEE END VIEWS BELOW)

3) ATTACH WIRES TO UNDERSIDE FRAMING WHERE NECESSARY USING SELF STICK WIRE CLIPS PROVIDED.

4) PLUG IN AND GO TO NEXT PAGE ON HOW TO OPERATE

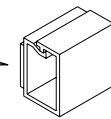

WIRE CLIP

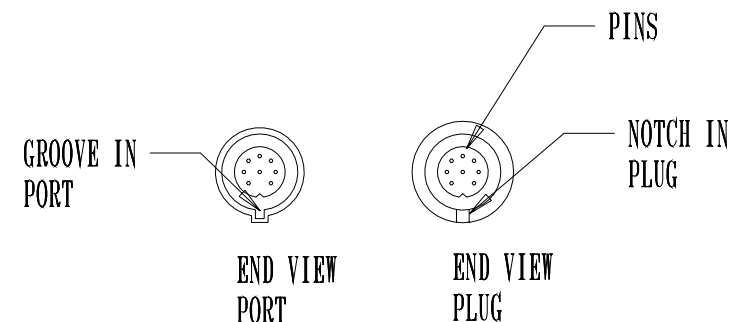
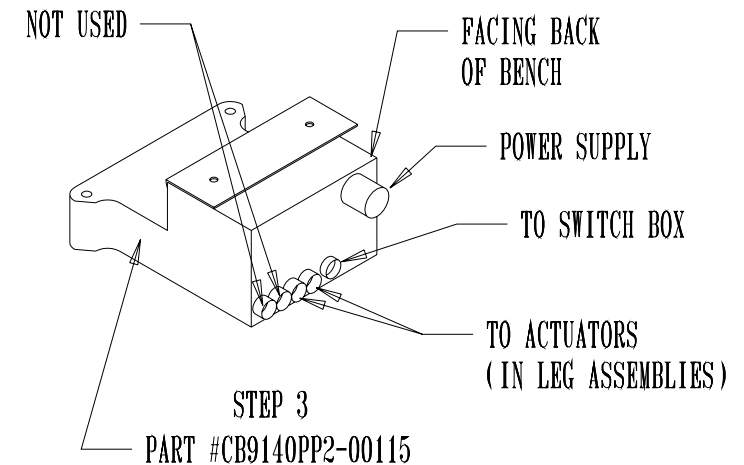
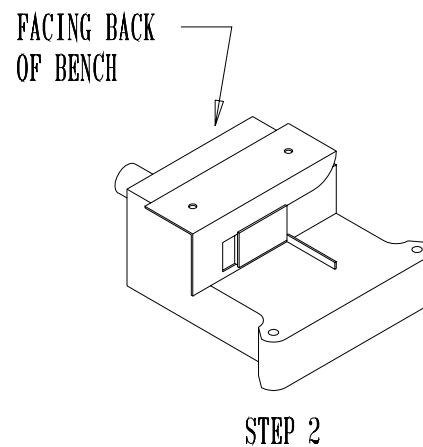
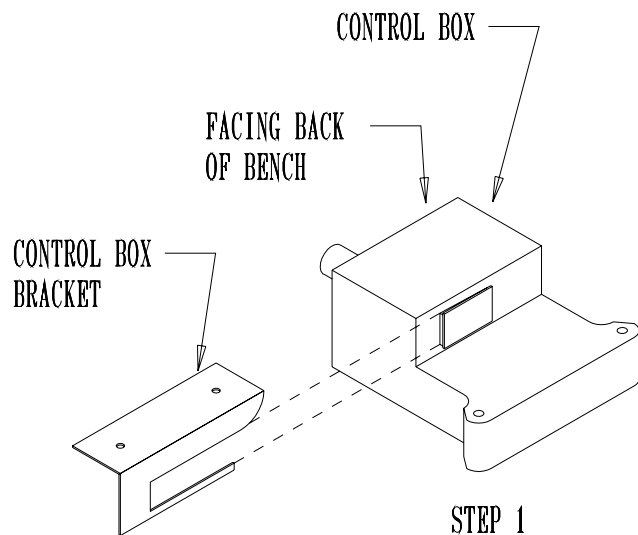

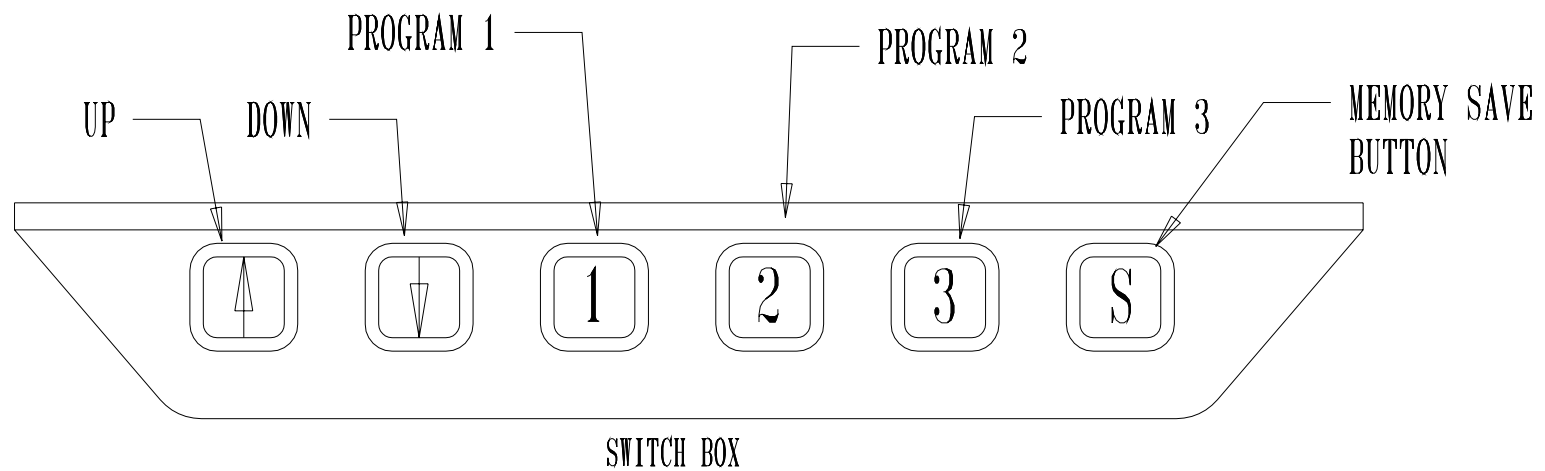

- 1) AFTER ALL PLUGS ARE SECURELY IN THEIR PORTS, PRESS THE DOWN BUTTON FOR APPROXIMATELY THREE SECONDS UNTIL A CLICK IS HEARD FROM THE CONTROL BOX, THEN RELEASE. (THIS SYNCHRONIZES THE LEG MOTORS)

NOTE: BE SURE TO FOLLOW STEP 1 BEFORE PRESSING THE UP BUTTON!!!

- 2) TO MOVE THE WORKSURFACE TO THE DESIRED HEIGHT PRESS AND HOLD THE UP OR DOWN ARROW UNTIL IT REACHES THE DESIRED HEIGHT AND RELEASE BUTTON.
- 3) FOR ADDED CONVENIENCE THREE (3) PROGRAM HEIGHTS CAN BE QUICKLY SAVED IN THE SWITCH BOX AS FOLLOWS

3a) USING THE UP OR DOWN ARROWS, MOVE THE WORKSURFACE TO THE DESIRED LOCATION AND RELEASE THE BUTTON. NEXT PRESS AND RELEASE THE "S" BUTTON AND THEN PRESS PROGRAM "1" (WITHIN 2 SECONDS) TO SAVE THAT PROGRAMMED HEIGHT. MOVE THE WORKSURFACE TO THE SECOND AND THIRD POSITIONS AND REPEAT THE PROGRAMMING SEQUENCE ABOVE.

3b) TO RETURN THE WORKSURFACE TO PROGRAMMED HEIGHT ALL THAT IS NEEDED NOW IS TO PRESS AND HOLD THE DESIRED BUTTON AND THE WORKSURFACE WILL AUTOMATICALLY RETURN TO THE SAVED POSITION.