

## Installation instructions for I950 cabinet

1. Remove screws attaching toe kick and remove toe kick.
2. Cut 2" x 4"  $\frac{1}{2}$ " less than interior width of cabinet shell.
3. Install 2" x 4" to the floor centered on cabinet width at a maximum distance from the wall to the front of 2" x 4" of 36-3/16", this distance may vary depending on length of cabinet run and straightness and plumb ness of wall.
4. Plumb cabinet shell and anchor to wall, at the top and middle of the shell, through perforated angle irons. Extra angle may need to be attached to upright angles if attaching to a stud wall. Extra blocking is required in a stud wall because of torque at the top of the shell when the insert is fully extended.

### FRONT VIEW OF SHELL

1.5" X 48" METAL PERFORATED METAL ANGLE FOR  
ATTACHMENT OF CABINET TO BUILDING WALLS

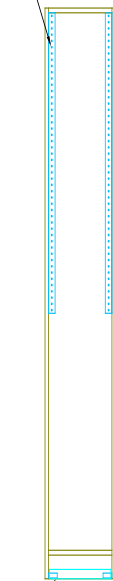

?? x ?? METAL ANGLE  
AT FRONT OF ENDS FOR  
ATTACHING CABINET TO  
2" x 4" BLOCKING AT FLOOR

5. Anchor shell to the 2" x 4" with angle brackets at the bottom of shell.
6. Reattach toe kick.
7. Screw all shells together in an elevation before installing inserts.
8. Block and shim insert to approximate height of 5-3/16". Extend drawer slides, center the front two drawer screws holes at top and bottom slides and install #10 x 3/4" pan head screws. If needed adjust insert so remaining screw holes are centered and install remaining screws. All screws must be installed in all available drawer slide holes.

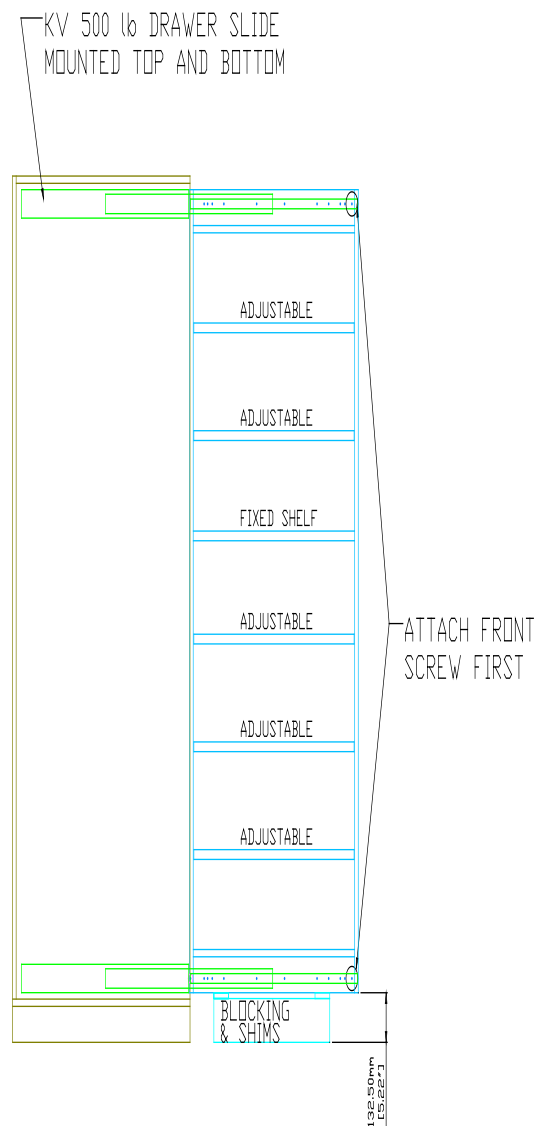

9. Attach front flush with bottom of end panel and centered left to right using (12) - #8 x 1-1/4" flat head screws through holes provided in sub front.
10. Attach pull using (2) - #8 x 2" flat head screws.

