

ADJUSTABLE STEEL GANTRY CRANE - SMS-46A-HAHS-8-15-14

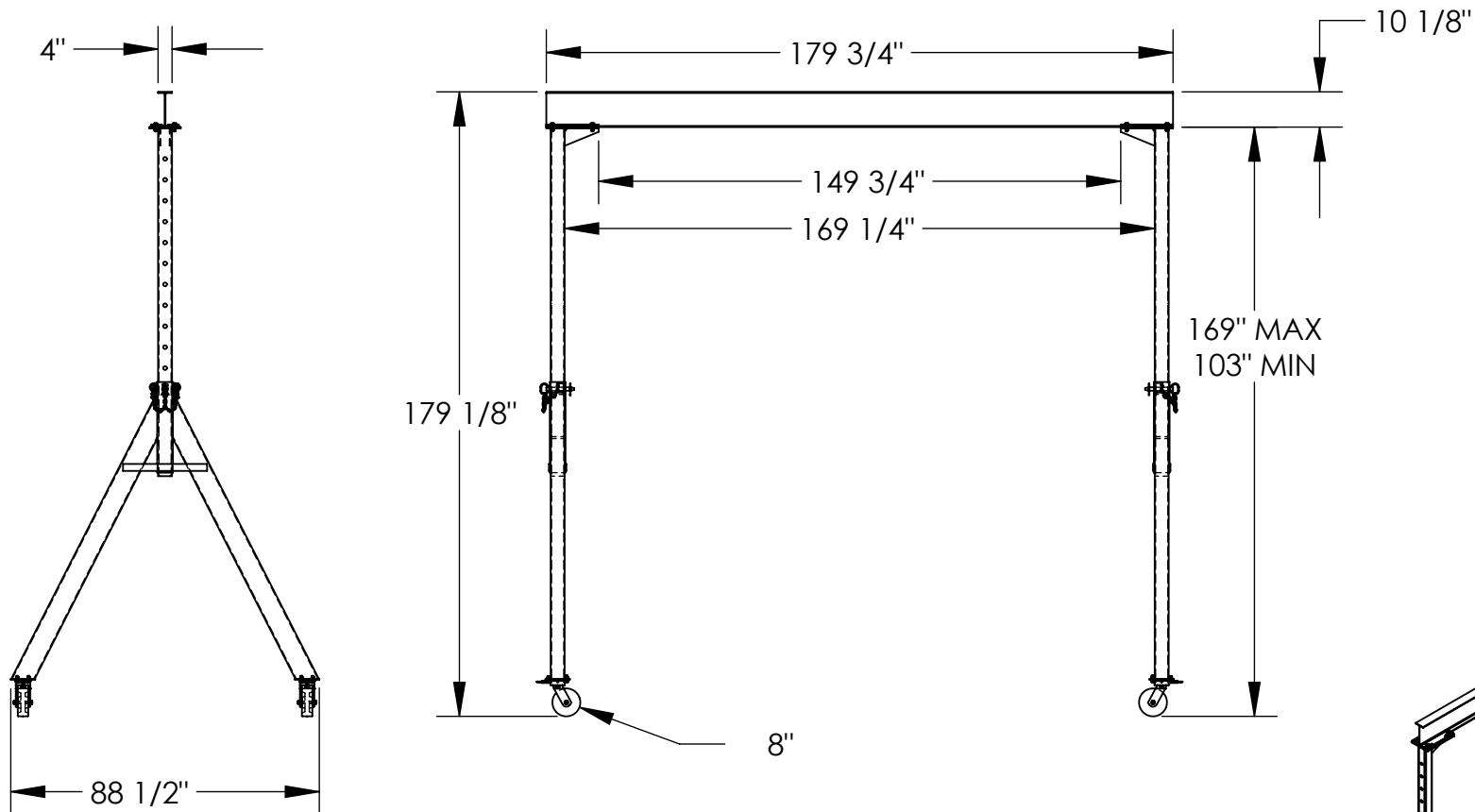

STANDARD FEATURES

MODEL NUMBER IS SMS-46A-HAHS-8-15-14

CAPACITY IS 8,000 LBS.

BASE WIDTH IS 88 1/2"

MAX OVERALL HEIGHT IS 179 1/8"

I-BEAM HEIGHT IS 10 1/8"

I-BEAM FLANGE WIDTH IS 4"

OVERALL I-BEAM LENGTH IS 179 3/4"

USABLE I-BEAM LENGTH IS 149 3/4"

ADJUSTABLE UNDER I-BEAM HEIGHT

169" MAX

103" MIN

HEIGHT IS ADJUSTABLE IN 6" INCREMENTS

CASTERS: (4) 8" X 3" WIDE PHENOLIC

SWIVEL CASTERS WITH FOUR

LOCKING POSITIONS

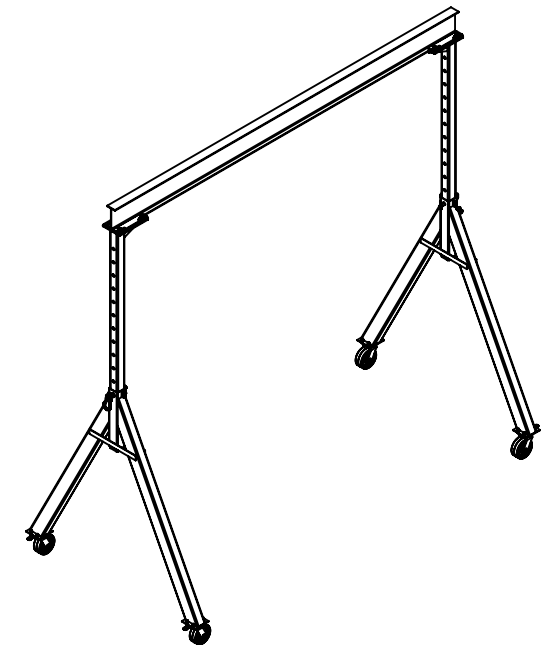

3D VIEW FOR REFERENCE ONLY



www.StoreMoreStore.com | 855-786-7667