



# INSTALLATION DETAILS

## **General Instructions**

1. Check material received against the packing list. Check the number of packages received and then check the contents of each package.
2. Check the material received for damage. If damage has occurred, secure a “damage notation” from the carrier
3. Identify each part as it is unpacked and put like parts together as close as possible to the working area where they are to be assembled.
4. Be careful to use the correct hardware as specified in the assembly instructions.

## **CAUTION**

In the interest of safety, all lockers must be securely anchored to the floor and/or wall. For safety, handle all components carefully and wear work gloves when assembling lockers. Install all units plumb and tighten all hardware securely. Retain instructions for future reference.

## **GUARDRAIL FLOOR ANCHORING INSTRUCTIONS**

### **Hardware Needed:**

- 5/8" X 4" Self Threading Anchor for Concrete
- 1/2" Carbide Drill Bit
- Wrench or Impact Wrench

### **Installation Steps for Concrete, Lightweight Concrete and Metal Deck:**

1. Using the 1/2" carbide drill bit, drill a hole at least 1" deeper than anchor embedment.
2. Using an impact wrench or manual socket wrench, insert anchor into hole and tighten anchor until fully seated. If installation torque exceeds 50 ft. lbs. using an impact wrench, remove anchor from hole. Reinstall with a new anchor using a manual socket wrench.

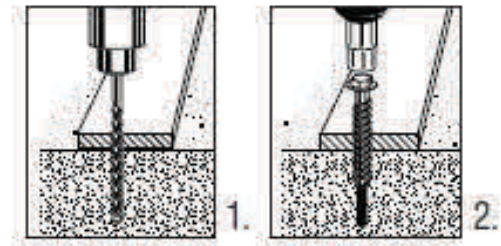

### **Caution:**

Observe torque values particularly when installing anchor in higher compressive strength concrete with and impact wrench. Over-torqueing may result in lower tension and/or shear performance of the anchor.

Use of core drills is not recommended to drill holes with this anchor.

Not recommended with use in new concrete which has not had sufficient time to cure.

Carbide drill bits are recommended for the installation of this anchor.

NOTES:  
1) USE PHC100 AT ALL UNUSED LOCATIONS

ITEM NO.	PART NUMBER	DESCRIPTION	QTY.
1	CS-1	18IN STANDARD COLUMN	1
2	GR-xx	GUARD RAIL SECTION	1
3	CS103	1/2-13 X 1-1/4 GRADE 5 HEX CAP SCREW	4
4	LDT100	5/8 X 4 LDT SELF THREADING ANCHOR	4
5	PHC100	PLASTIC HOLE COVER	6

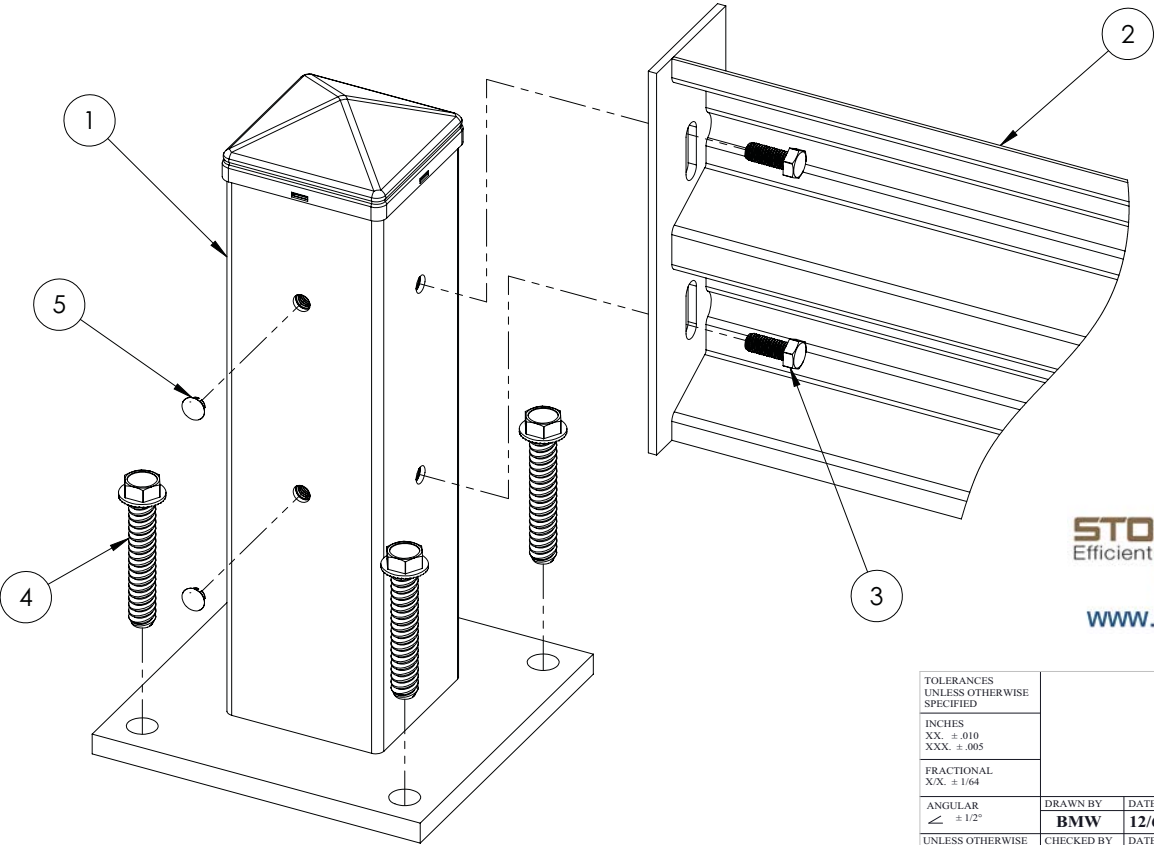

**STOREMORESTORE**  
Efficient Productive Storage Products  
1-855-786-7667  
WWW.STOREMORESTORE.COM

TOLERANCES UNLESS OTHERWISE SPECIFIED								
INCHES XX. ± .010 XXX. ± .005								
FRACTIONAL X/X. ± 1/64								
ANGULAR ∠ ± 1/2°	DRAWN BY <b>BMW</b>	DATE <b>12/6/2012</b>	<b>CS-1 CONNECTION DETAIL</b>					
UNLESS OTHERWISE SPECIFIED ALL DIMENSIONS ARE IN INCHES. METRIC DIMENSIONS WILL BE WITHIN [XX]	CHECKED BY	DATE						
	APPROVED BY	DATE	SCALE	SHEET	PART NO.	DRAWING NO.	REV.	
				<b>1 OF 1</b>		<b>SA-1559</b>		

THIS DRAWING AND THE INFORMATION ON IT IS THE CONFIDENTIAL PROPERTY OF HALLOWELL, AND SHALL NOT BE COPIED OR DISCLOSED TO OTHERS WITHOUT WRITTEN PERMISSION. ONLY HALLOWELL RESERVES THE RIGHT TO ALTER ANY DESIGN. ANY UNAUTHORIZED MODIFICATIONS RELEASES HALLOWELL FROM ALL LIABILITIES.

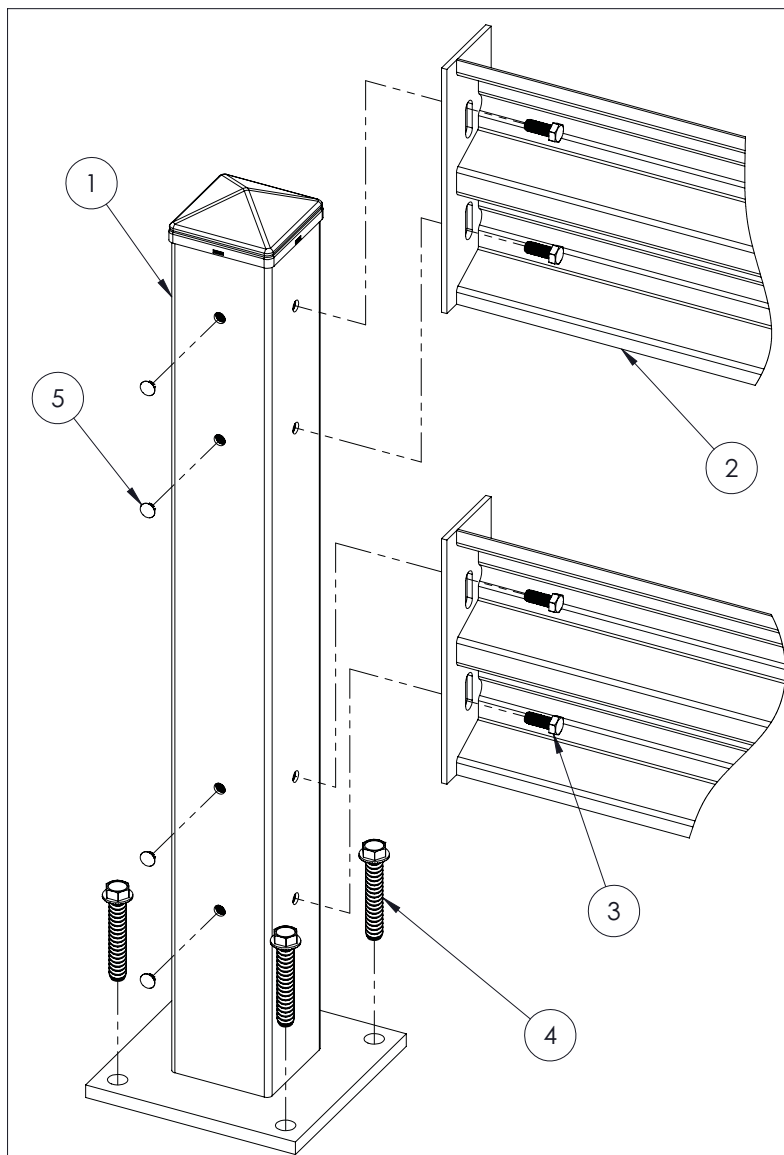

ITEM NO.	PART NUMBER	DESCRIPTION	QTY.
1	CS-2	42IN STANDARD COLUMN	1
2	GR-xx	GUARD RAIL SECTION	2
3	CS103	1/2-13 X 1-1/4 GRADE 5 HEX CAP SCREW	8
4	LDT100	5/8 X 4 LDT SELF THREADING ANCHOR	4
5	PHC100	PLASTIC HOLE COVER	12

NOTES:

1) USE PHC100 AT ALL UNUSED LOCATIONS

  
**STOREMORESTORE**  
 Efficient Productive Storage Products  
**1-855-786-7667**  
[www.StoreMoreStore.com](http://www.StoreMoreStore.com)

TOLERANCES UNLESS OTHERWISE SPECIFIED										
INCHES XX. ± .010 XXX. ± .005										
FRACTIONAL X/X. ± 1/64										
ANGULAR ∠ ± 1/2°	DRAWN BY <b>BMW</b>	DATE <b>12/10/2012</b>	DESCRIPTION		<b>CS-2 CONNECTION DETAIL</b>					
UNLESS OTHERWISE SPECIFIED ALL DIMENSIONS ARE IN INCHES. METRIC DIMENSIONS WILL BE WITHIN [XX]	CHECKED BY	DATE								
	APPROVED BY	DATE	SCALE	SHEET	PART NO.	DRAWING NO.	REV.			
			:	<b>1 of 1</b>		<b>SA-1560</b>				

THIS DRAWING AND THE INFORMATION ON IT IS THE CONFIDENTIAL PROPERTY OF HALLOWELL, AND SHALL NOT BE COPIED OR DISCLOSED TO OTHERS WITHOUT WRITTEN PERMISSION. ONLY HALLOWELL RESERVES THE RIGHT TO ALTER ANY DESIGN. ANY UNAUTHORIZED MODIFICATIONS RELEASES HALLOWELL FROM ALL LIABILITIES.

NOTES:  
1. USE PHC100 AT ALL UNUSED LOCATIONS

ITEM NO.	PART NUMBER	DESCRIPTION	QTY.
1	CS-1	18IN STANDARD COLUMN	1
2	GR-xx	GUARD RAIL SECTION	1
3	CS103	1/2 X 1-1/4 GRADE 5 EX CAP SCREW	4
4	LDT100	5/8 X 4 LDT SELF THREADING ANCHOR	4
5	PHC100	PLASTIC HOLE COVER	6
6	LOA	LIFT OUT ADAPTER	1
7	45-BRACKET	ANGLE BRACKET	--

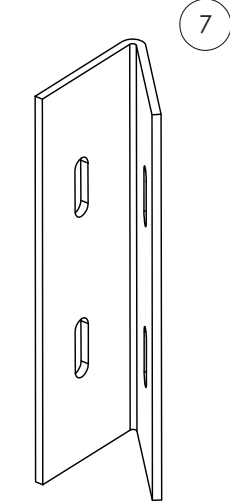
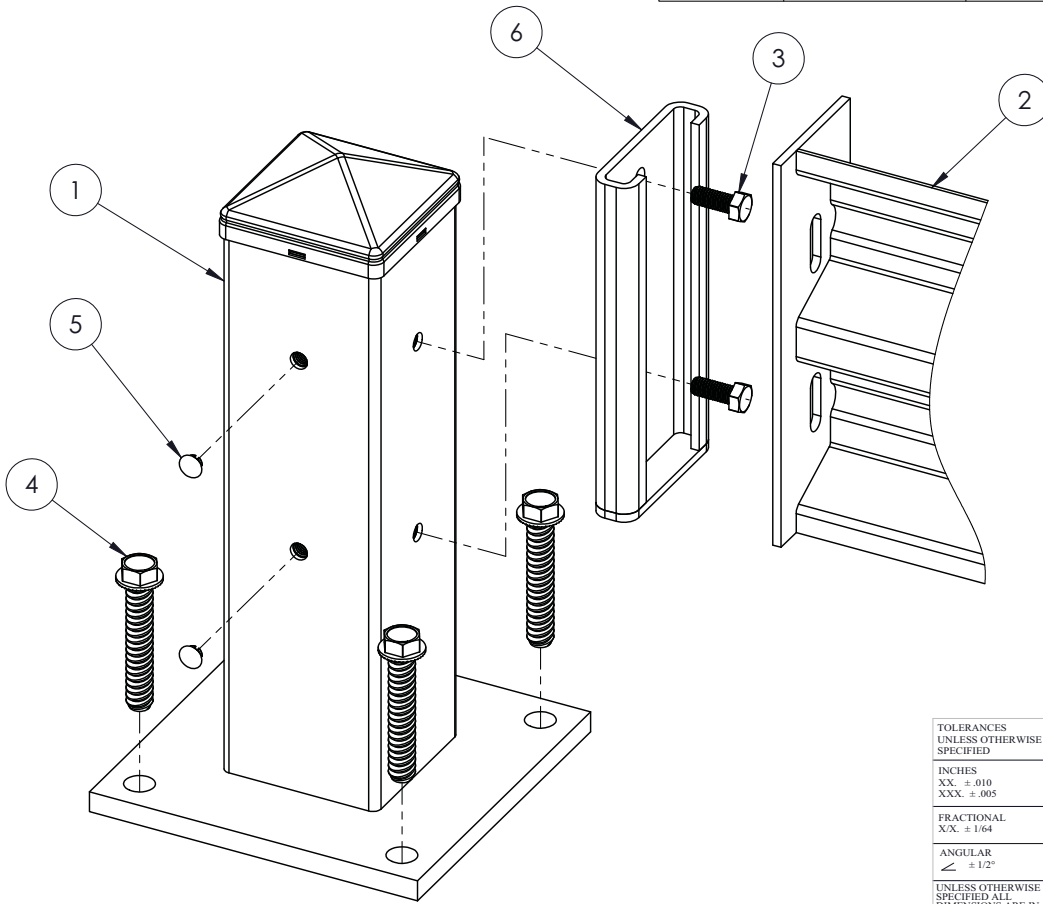

ANGLE BRACKET  
CAN BE USED  
INSTEAD OF  
LIFT OUT ADAPTER

TOLERANCES  
UNLESS OTHERWISE  
SPECIFIED  
INCHES  
XX. ± .010  
XXX. ± .005  
FRACTIONAL  
X/X. ± 1/64

ANGULAR  
± 1/2°

UNLESS OTHERWISE  
SPECIFIED ALL  
DIMENSIONS ARE IN  
INCHES. METRIC  
DIMENSIONS WILL BE  
WITHIN [XX]

**STOREMORESTORE**  
Efficient Productive Storage Products  
1-855-786-7667  
www.StoreMoreStore.com

DRAWN BY	DATE	DESCRIPTION				
JIL	7/18/2013	LIFT OUT ADAPTER & ANGLE BRACKET				
CHECKED BY	DATE					
APPROVED BY	DATE	SCALE	SHEET	PART NO.	DRAWING NO.	REV.
		:	1 OF 1		SA1642	

THIS DRAWING AND THE INFORMATION ON IT IS THE CONFIDENTIAL PROPERTY OF HALLOWELL, AND SHALL NOT BE COPIED OR DISCLOSED TO OTHERS WITHOUT WRITTEN PERMISSION. ONLY HALLOWELL RESERVES THE RIGHT TO ALTER ANY DESIGN. ANY UNAUTHORIZED MODIFICATIONS RELEASES HALLOWELL FROM ALL LIABILITIES.